



SR 4017 BRUSH HILL ROAD

RECONSTRUCTION AND WIDENING PROJECT

PITTSBURGH INTERCHANGE (EXIT 57) TO IRWIN INTERCHANGE (EXIT 67)

DETOUR MAP - 8 MILE DETOUR ROUTE

OWNER NAMES

PRELIMINARY NOVEMBER 12, 2015

BOARD #17

(218) ROBERT J. FROGGATT AND LINDA J. FROGGATT (HIS WIFE)

(221) JONNA L. FLANNERY AND JACQUELINE LIEBZINSKI CO-EXECUTRICES OF THE ESTATE OF JOHN J. CARRERA

(220) JONNA L. STANOSZEK, SINGLE

(222) JONNA L. FLANNERY

(223) WILLIAM J. KAMINSKY AND DONNA J. KAMINSKY, HUSBAND AND WIFE

LEGEND

- PROPOSED ROADWAY
- PROPOSED SHOULDER
- TRANSITION ROADWAY
- TRANSITION SHOULDER
- PROPOSED STRUCTURE
- REQUIRED RIGHT-OF-WAY
- LEGAL RIGHT-OF-WAY LINE
- REQUIRED RIGHT-OF-WAY LINE
- PROPERTY LINE
- PROPOSED EASEMENT
- TEMPORARY CONSTRUCTION EASEMENT
- PROPOSED CUT LINE
- PROPOSED FILL LINE
- PARCEL (NOT AFFECTED)
- PARCEL (AFFECTED)
- EXISTING RIGHT-WAY-FENCE
- EXISTING DRAINAGE
- PROPOSED DRAINAGE
- PROPOSED DITCH
- EXISTING WETLANDS
- EXISTING WATERWAY
- STORMWATER MANAGEMENT BASIN
- PROPOSED TRAIL
- ELIMINATION OF PARKING AREA, TYPE B
- GUIDE RAIL
- RETAINING WALL
- SOUND BARRIER
- DIRECTION OF TRAVEL

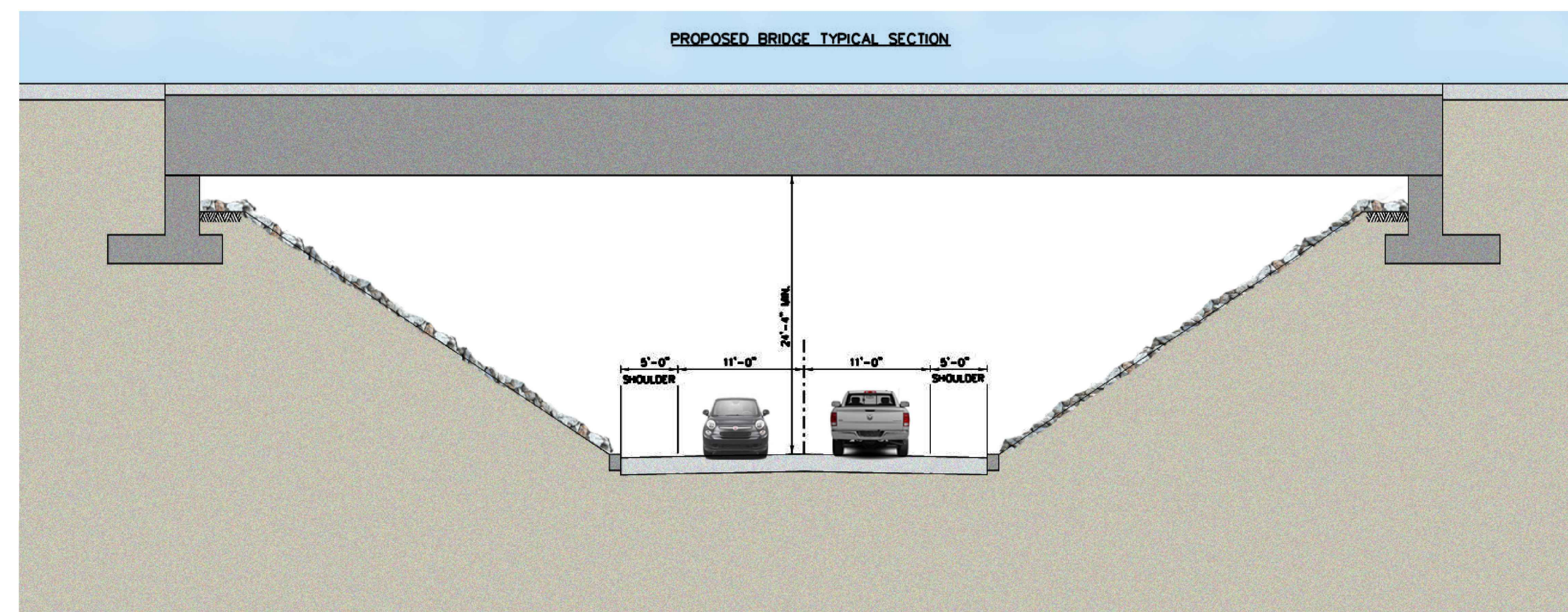
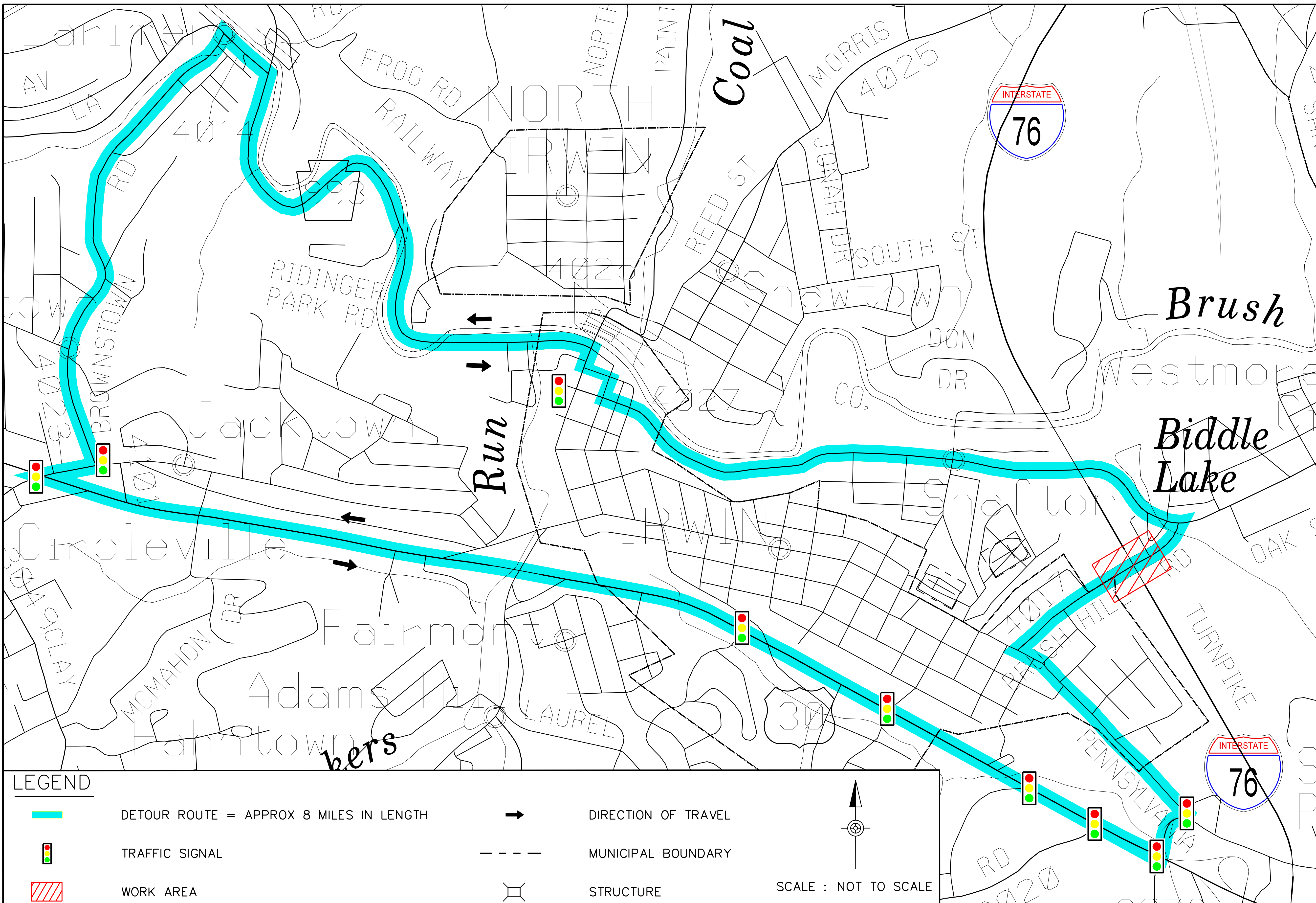
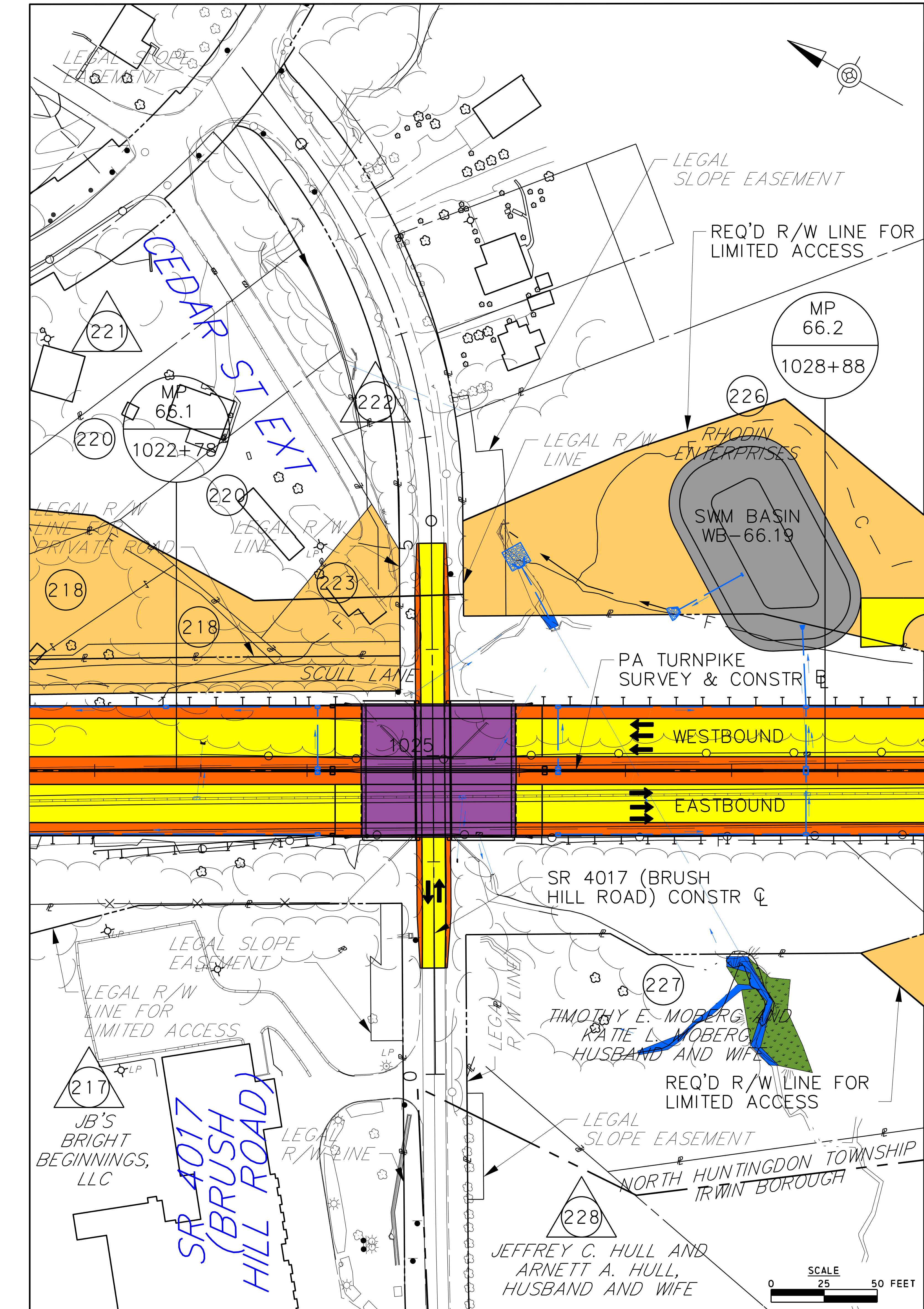

PROPOSED CONDITION

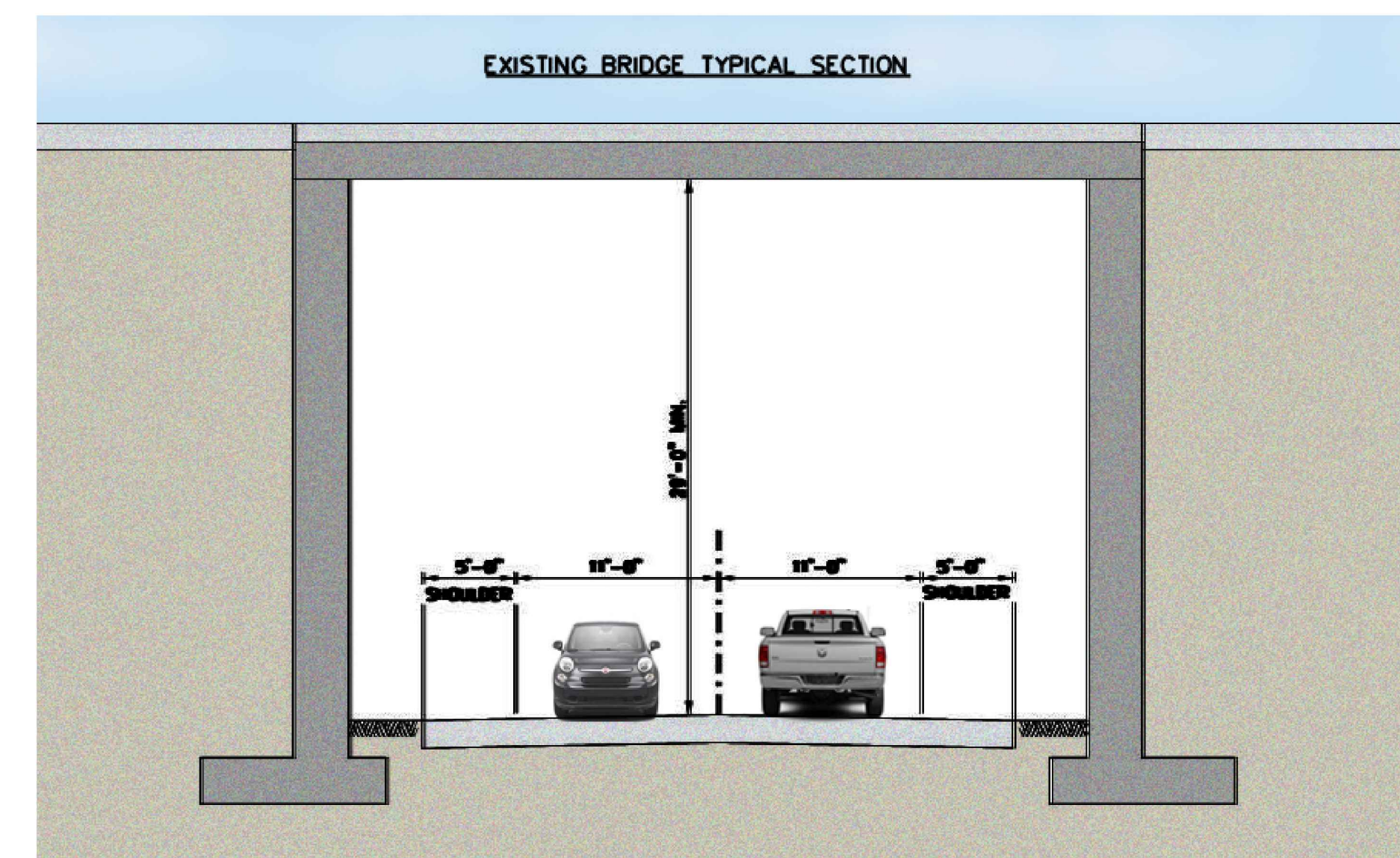

EXISTING CONDITION