

OWNER NAMES	
7	JOSEPH S. DENINNO AND KATHLEEN DENINNO, HUSBAND AND WIFE
8	MARTIN LIEB AND ALICE LIEB, HUSBAND AND WIFE
9	WILLIAM BRADLEY GRANTHAM AND CYNTHIA VALDES GRANTHAM, HUSBAND AND WIFE
10	PARAMESHWAR RAMKUMAR MIDHE AND MADHAVI LATHA DESAI, HUSBAND AND WIFE
11	SANTOSH KUMAR MUPPARAPU AND HUSBAND AND WIFE VENKAT LAKSHMI DEEPTI CHITTA,
12	RICHARD L. CROKER AND NANCY CROKER, HUSBAND AND WIFE
13	HOWARD S. SHUTE AND MARILYN T. SHUTE, HUSBAND AND WIFE
14	SRINIVASU CHERUPALLY, A MARRIED INDIVIDUAL
15	CAROLYN L. RUFFER, UNMARRIED
16	ROBERT P. HENNESSEY AND KIMBERLY A. HENNESSEY, HUSBAND AND WIFE
17	BERKLEY SQUARE PLANNED COMMUNITY ASSOCIATION, INC. EUGENE TABONE AND LINDA M TABONE, HUSBAND AND WIFE, CAROLYN REED URSULA M. CHOUGH AND ANDREW CHOUGH, HUSBAND AND WIFE, EDGAR D. THOMPSON AND ALBERTA V. THOMPSON, HUSBAND AND WIFE
18	FRANK M. KINKELLA AND SARA SUE KINKELLA, HUSBAND AND WIFE, MARVIN E. WASPE AND CECILIA J. WASPE, HARRY W. BUCKLEY AND CAROL M. BUCKLEY, HUSBAND AND WIFE, NICHOLAS S. CHIRIGOS AND CLAUDIA E. FARMER, AS JOINT TENANTS WITH RIGHT OF SURVIVORSHIP



LEGEND

	PROPOSED ROADWAY		LEGAL RIGHT-OF-WAY LINE		PROPOSED CUT LINE		STORMWATER MANAGEMENT BASIN
	PROPOSED SHOULDER		REQUIRED RIGHT-OF-WAY LINE		PROPOSED FILL LINE		PROPOSED TRAIL
	TRANSITION ROADWAY		PROPOSED EASEMENT		EXISTING DRAINAGE		GUIDE RAIL
	TRANSITION SHOULDER		TEMPORARY CONSTRUCTION EASEMENT		PROPOSED DRAINAGE		RETAINING WALL
	PROPOSED STRUCTURE		PARCEL (NOT AFFECTED)		PROPOSED DITCH		SOUND BARRIER
	REQUIRED RIGHT-OF-WAY		PARCEL (AFFECTED)		EXISTING WETLANDS		DIRECTION OF TRAVEL
	PROPERTY LINE		EXISTING RIGHT-WAY-FENCE		EXISTING WATERWAY		

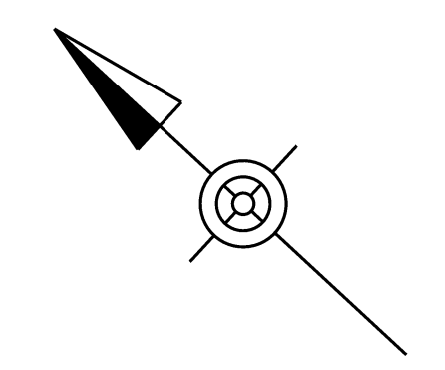