

LEGEND

- PROPOSED ROADWAY
- PROPOSED SHOULDER
- PROPOSED STRUCTURE
- REQUIRED RIGHT-OF-WAY ACQUISITION
- MILLING AND OVERLAY
- LEGAL RIGHT-OF-WAY LINE
- REQUIRED RIGHT-OF-WAY LINE
- TEMPORARY CONSTRUCTION EASEMENT
- PROPOSED CUT LINE
- PROPOSED FILL LINE
- 1 PARCEL (AFFECTED)
- 5 PARCEL (NOT AFFECTED)
- X PROPOSED RIGHT-OF-WAY FENCE
- EXISTING DRAINAGE
- PROPOSED DRAINAGE
- EXISTING WETLAND
- EXISTING WATERWAY
- STORMWATER MANAGEMENT BASIN (SWM)
- PROPOSED RETAINING WALL
- PROPOSED SOUND BARRIER

BOARD #1


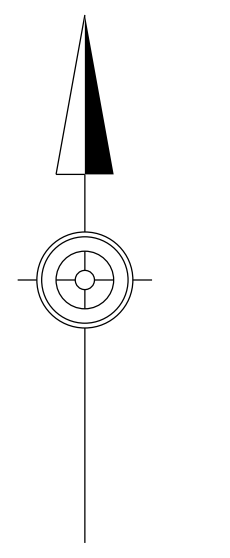

10
 N/F EARL W. KIMBLE & D. JOYCE KIMBLE, his wife, as tenants by the entireties of an undivided two-third interest held jointly with their son, SCOTT W. KIMBLE, as to the remaining undivided one-third interest, as joint tenants with right of survivorship

2
 N/F ARNOLD L. MARTIN & VERA E. MARTIN, his wife

3
 N/F ALLEN W. BOOR & TANYA J. BOOR, husband and wife

9
 SCOTT W. KIMBLE, LARUE J. MCCARRAHAN, and DANIEL E. KIMBLE, TENANTS IN COMMON

8
 N/F EARL W. KIMBLE & D. JOYCE KIMBLE, his wife, as tenants by the entireties of an undivided one-half interest held jointly with their son, SCOTT W. KIMBLE, as to the remaining undivided one-half interest, as joint tenants with right of survivorship

11
 N/F BUCK RIDGE HUNTING CLUB, a Pennsylvania general partnership

13
 N/F H. DALE CHAMBERLAIN & LINDA KAY CHAMBERLAIN, his wife, as tenants by the entireties

14
 N/F THOMAS W. STIFFLER & SHARON J. STIFFLER, his wife

SCALE
 0 100 200'